

# INSTALLATION INSTRUCTIONS

---

## *Installation and Maintenance Manual* **K601D-T/S/P (LED)**

### **WARNING:**

Read these instructions carefully before attempting to install or maintain this product. Work must be done by qualified personnel. Improper installation or maintenance may result in personal injury or death or significant property damage.

### **INSTALLATION WARNING:**

Be certain that all electrical power is disconnected from the fixture before installing or maintaining the fixture. Failure to do so may result in personal injury or death.

### **CAUTION:**

Supply conductors that are run through the inside of a pole shall be supported by means capable of preventing injury and strain on the conductors.

### **CAUTION:**

Under no circumstances should the complete fixture, including the globe, be installed on the street light pole and arm on the ground prior to the pole being erected. Installing the complete and assembled luminaire to the pole/arm prior to pole erection and then erecting the pole with the complete luminaire attached will result in VOIDING of the King Luminaire warranty.

*In its ongoing commitment to continuous improvement, King Luminaire Inc. reserves the exclusive right to change materials and designs without notice.*



## ***Introduction***

### ***PRODUCT DESCRIPTION:***

The K601D LED luminaire is designed and tested in accordance with UL1598 (prev. UL1571 and UL1572) and CSA C22.2 No. 250-00.

- » The fixture is designed to operate LED light sources up to 150 watts.
- » All electrical components, including the LED flat array engine and driver assembly, may be removed from the fixture; electrical connections must be turned off and disconnected.

## ***Tools & Materials Needed:***

### ***TENON MOUNT INSTALLATION***

- » 3/16" Allen Key

### ***SIDE MOUNT INSTALLATION***

- » Adjustable Wrench

### ***PENDANT MOUNT INSTALLATION***

- » 1/8" Allen Key
- » 3/16" Allen Key
- » Pipe Sealer (Teflon Tape recommended)

## ***Questions***

If additional information is required, please contact:

King Luminaire Co. Inc.  
Customer Service Department  
**1-800-268-7809**  
scgrp.com

Rev: April 29, 2025





## Fixture Installation

### TENON MOUNT

1. Erect the street light pole.
2. Remove the Luminaire from the packaging and check for damage incurred during shipping.
3. Check that the voltage noted on the power leads sticker is the same as the power supply voltage.
4. After the Pole is erected and secured, connect the power leads from the Pole to the supplied Luminaire power wires.
5. Slide the Luminaire over the tenon and orient it so that 'House Side'/Hinge Side faces away from the street.
6. Tighten the set screws on the Luminaire to secure it to the tenon of the pole.
7. Connect the electrical power supply and check for proper operation.

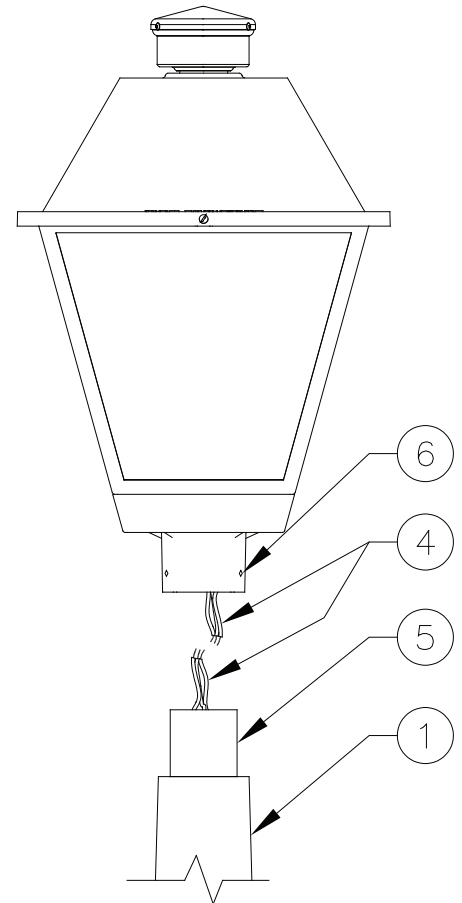

# INSTALLATION INSTRUCTIONS: K601D



## SIDE MOUNT

1. Erect the street light Pole and have the Arm assembled to the Pole if not already done. It is recommended to assemble the Arm after the pole is erect. Make sure the Arm is wired with the leads exiting the end of the Arm.
2. Remove the Luminaire from the packaging and check for damage incurred during shipping.
3. Check that the voltage noted on the power leads sticker is the same as the power supply voltage.
4. Check that the (4) 3/8"-16 Mounting Hex Bolts are threaded into the Lid so the threads are exiting the back side. Remove the 3/8"-16 Hex Nuts and Washers (Lock and Flat) and keep for later assembly.
5. Raise the Luminaire close to the end of the Arm and insert the wires from the arm thru the center wiring hole in the Lid.
6. Slide the (4) 3/8-16 Hex Bolts exiting the back of the Lid thru the mating holes on the Arm Mounting Plate. Make sure the Square Rubber Gasket is between the Lid and Arm Mounting Plate. Apply the 3/8-16 Hex Nuts, Flat and Lock Washers to the back side of the Arm Mounting Plate and fully tighten.
7. Open the Lid and connect the wiring electrical power supply and check for proper operation.

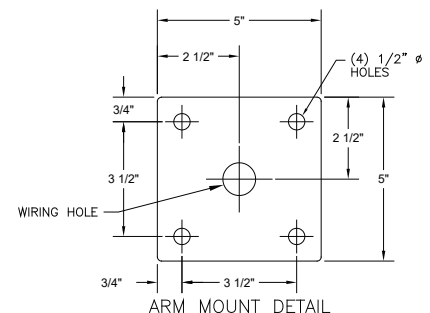
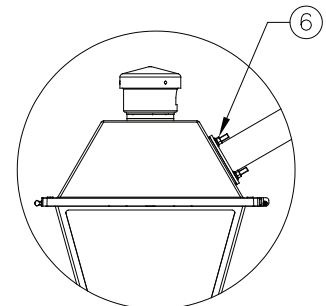
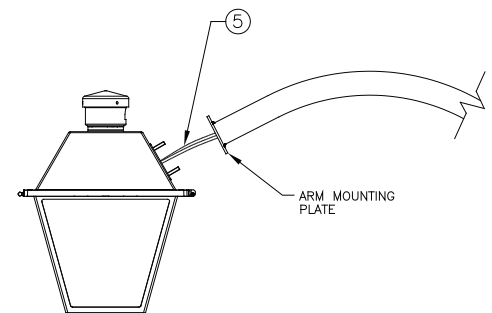
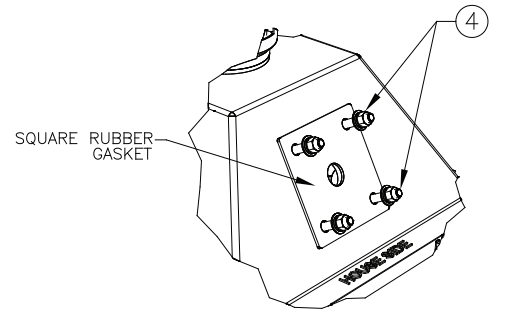



## PENDANT MOUNT

1. Erect the street light Pole and have the Arm assembled to the Pole if not already done. It is recommended to assemble the Arm after the pole is erect. Make sure the Arm is wired with the leads exiting the end of the Arm.
2. Remove the Luminaire from the packaging and check for damage incurred during shipping.
3. Check that the voltage noted on the power leads sticker is the same as the power supply voltage.
4. Apply Sealing Compound to the threads of the 1-1/4" NPT Leveling Device Shaft. Place the Leveling Device Shaft into the Leveling Device Housing and thread the Leveling Device Shaft into the 1-1/4" NPT hole in the Luminaire Lid and fully tighten. Lock the Leveling Device Shaft in place by tightening the 1/4-20 Locking Set Screw in the Lid. If for any reason the Luminaire must be removed from the Leveling Device Shaft the Locking Set Screw MUST be loosened.
5. Apply Sealing Compound to the pipe threads at the end of the Arm. Pull the power supply wires through the Leveling Device Housing and into the Luminaire. Thread the Leveling Device Housing to the Arm and fully tighten. Lock in place by tightening the 1/4-20 Locking Set Screw in the Leveling Device Housing. This screw MUST be loosened if the removal of the luminaire is required for any reason.
6. Orientation of the Luminaire: Physically turn the luminaire so that the Leveling Device Shaft rotates within the Leveling Device Housing until the Lid Hinges point to the House Side (note House Side is noted on the Lid). To lock in place tighten the (4) 3/8-16 set screws located in the Leveling Device Housing thereby locking the Leveling Device Shaft within the Housing.
7. Open the Lid and connect the wiring electrical power supply and check for proper operation.
8. See last page of Instructions for Pendant Luminaire/Leveling Device Representations.

## Maintenance

**WARNING:** Be certain that all electrical power is disconnected from the fixture before installing or maintaining the fixture. Failure to do so may result in personal injury or death.

### CLEANING:

Wipe off exterior dirt and debris before opening or removing the lens. Wipe the lens with a clean soft dry cloth. If the lens needs to be washed, use soap and water. Do not use any abrasive cleaners on optical surfaces. Close or re-install the lens and secure.



# INSTALLATION INSTRUCTIONS: K601D

