



## K425 CLASSIC ACORN - LED

The K425 Classic Acorn offers a sophisticated version of the traditional globe with efficient optical performance, careful engineering and incredibly easy maintenance characteristics, without compromising the historical authenticity of the product's appearance.



**King  
Luminaire**

## PRODUCT SPECIFICATIONS

### LED ENGINE

The light engine shall be an array of Cree Surface Mounted diodes mounted to a highly conductive aluminum extrusion with the use of 2 electrical connectors. The aluminum extrusion shall be mechanically attached to a thermal heat sink at both the top and the bottom of the aluminum extrusion. It shall remain in thermal contact to the heat sinks with the use of conductive silicone. There shall be an aluminum uplight reflector available in Type III or Type V IESNA distribution patterns.

### REFRACTIVE GLOBE

The prismatic refractor shall be made of injection moulded acrylic or polycarbonate and produce Type III or Type V IESNA distribution patterns. It shall maintain a minimum thickness of 1/4".

The acrylic globe shall be secured to the luminaire body by means of a split-clamping ring of durable cast aluminum, which allows easy, tool-less removal of the globe assembly from the luminaire body by means of King Luminaire's Rotolock™ system.

A minimum ingress protection against water or dust particles of IP66 for the LED optical chamber shall be provided by non-porous, closed-cell silicon rubber sponge gasketing which is highly efficient in sealing against particle ingress for a wide temperature range (-40°F to 310°F).

### LUMINAIRE CONSTRUCTION

All K425 Classic Acorn cast components shall consist of a heavy cast aluminum. The main body, or capital, shall act as an enclosure for the driver assembly and shall be of adequate thickness to give sufficient structural rigidity. The capital shall have an opening at the base tenon body to allow the luminaire to be mounted to a tenon of 3-1/2" maximum diameter x 3-1/2" maximum length. The luminaire shall be locked in place by means of heavy duty, stainless-steel set-screws.

### DRIVER

The LED universal dimmable driver shall be DALI-2 D4i and capable of 108 - 305V or 249 - 528V input voltage, greater than 0.9 power factor, and less than 20% total harmonic distortion. Each LED system shall come with built-in, high-capacity surge protection, in addition to a complementary SPD added by King Luminaire, designed to withstand up to 20kV/10kA of transient line surge as per IEEE C62.41.2 C High and ANSI C136.2 Extreme Level (20kV/10kA). An in-line ferrite choke shall be utilized to provide protection against EFT's. The driver assembly shall work with service feeds powered with one hot wire and a neutral or two hot wires. The case temperature of the driver shall range from -40°C up to 70°C. The driver assembly shall be mounted on a heavy duty fabricated aluminum mounting bracket.

### PHOTOMETRICS

Fixtures shall be tested to IESNA LM79 specifications. These reports are to be available upon request.

### CHROMATICITY

High output LEDs come standard at 2700K, 3000K, & 4000K (+/- 300K) with a minimum nominal 70 CRI. Additional CCT emitters are to be available upon request.

### LUMEN MAINTENANCE

Reported (TM21) and Calculated (L70) reports are to be available upon request with a minimum calculated value of 100,000 hrs.

### WIRING

All internal wiring and connections shall be completed so that it will be necessary only to attach the incoming supply connectors to Mate-N-Lok connectors or to a terminal block. Mate-N-Lok shall be certified for 600V operation. Internal wire connectors shall be crimp connector only and rated at 1000V and 105°C. All wiring to be CSA certified and/or UL listed, type SFF-2, SEWF-2, or SEW-2 No. 14 gauge, 105°C, 600V.

### THERMALS

Fixtures shall be tested to determine the maximum in-situ case temperature of the LED emitters as recommended by Cree. This report is to be available upon request.

### FINISH

Housing shall be finished with a 13 step Kingcoat™ SuperDurable polyester TGIC powder coat. Standard colors shall include strobe white, brown metal, marina blue, gate gray, Chicago bronze, standard gold, standard black, federal green, and rain forest. Additional RAL or custom color matches are to be available. Please see our website for a complete list of colors.

### MISCELLANEOUS

All exterior hardware and fasteners, wholly or partly exposed, shall be stainless-steel alloy. All internal fasteners shall be stainless-steel or zinc coated steel. All remaining internal hardware shall be stainless steel, aluminum alloy, or zinc coated steel.

### WARRANTY

The K425 Classic Acorn LED luminaire shall come with a 7 year limited warranty.

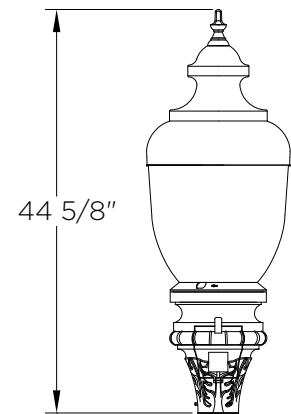

### CERTIFICATION:

Suitable for wet locations  
ISO 9001  
IP66  
ARRA Compliant  
LM79 / LM80 Compliant

### DRIVER INFO:

>0.9 Power Factor  
<20% Total Harmonic Distortion  
120 - 277V & 347 - 480V  
-40°C Min. Case Temperature  
60°C Max. Case Temperature  
Surge Protection: ANSI 136.2  
extreme level 20 kV/10 kA  
Dimming Capable

### EPA:

1.40 sq. ft.

### FIXTURE WEIGHT:

Contact King Luminaire



Not all product variations listed on this page are DLC qualified.  
Visit [www.designlights.org/search](http://www.designlights.org/search) to confirm qualification.  
06-06-2025

## FIXTURE OPTIONS

K425 CLASSIC ACORN - LED

## Capital Options

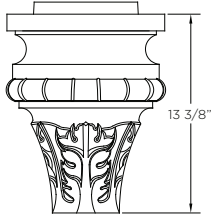

K13

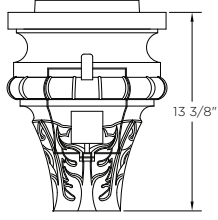

K14 C/W PR

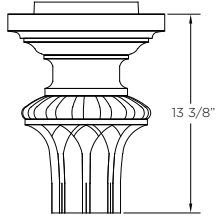

K16

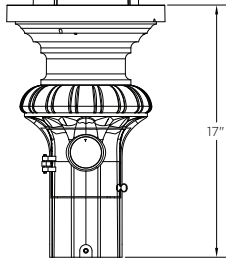

K18 C/W PR

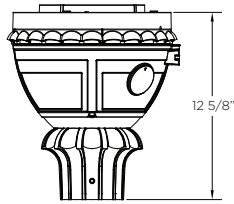

K26 C/W PR

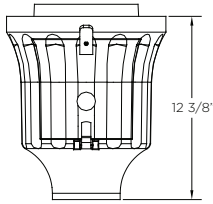

K24 C/W PR

## Finial Options

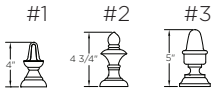

## HOW TO ORDER

